

No 45

217.8
N 217 1/4

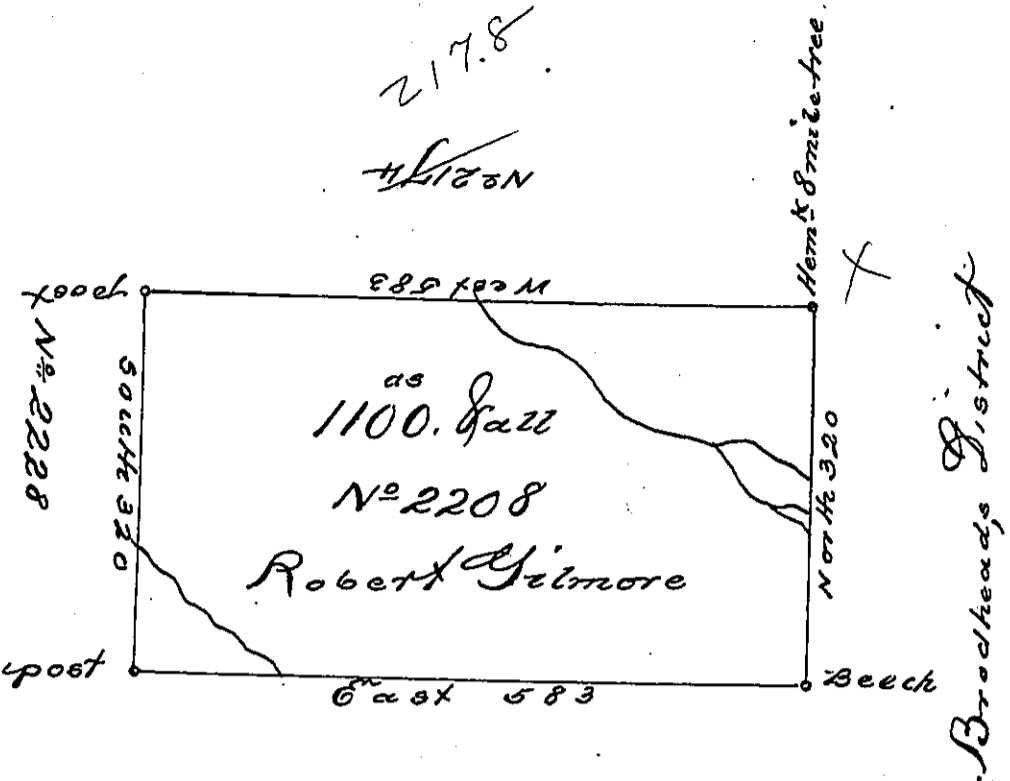

Situate about three miles South of the Oswayo Creek in North
 County. containing 1100 acres and the usual allowance for Roads &c
 Surveyed June 1st 1793 for Robert Gilmore in pursuance of a
 warrant N^o. 2208, - bearing date 12th December 1792.

Daniel Brodhead Esq.
 S.Y.

John Canan A.S.

IN TESTIMONY that the above is a copy of the original remaining on file in
 the Department of Internal Affairs of Pennsylvania, made
 conformably to an Act of Assembly approved the 16th day of
 February, 1833, I have hereunto set my Hand and caused
 the Seal of said Department to be affixed at Harrisburg,
 this fourth day of October, 1898

James W. Patta
 Secretary of Internal Affairs.